



Model Number:
F-LPBX-7048

RF Components

Broadband Low pass Filter

DC-2000 MHz

Physical Dimensions ($\pm 0.3\text{mm}$)

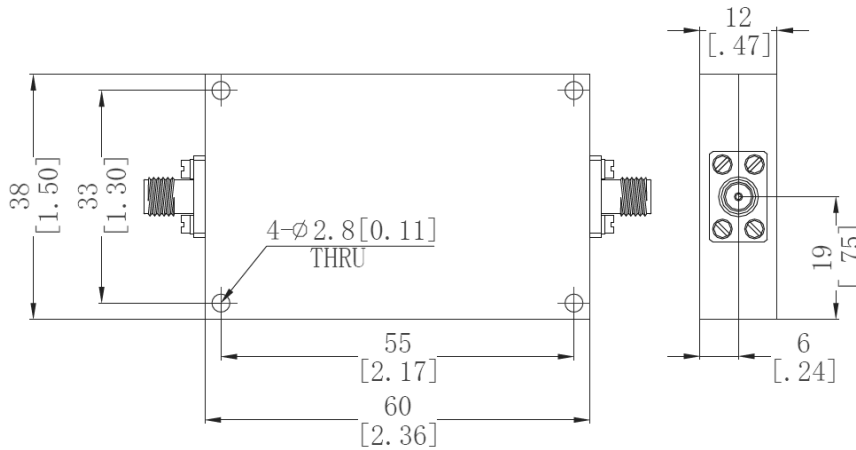

Filter

RF Parameters	
F-BPBX-7048	S5S5
Frequency Range	DC—2000 MHz
RF Connectors	50Ω SMA Female
Insertion Loss (dB)	$\leq 1.2\text{dB}$
VSWR (dB) Max	1.8:1
Rejection	$\geq 50\text{ dB}@2300\text{-}7000\text{ MHz}$
Max RF Power	15 W

Environmental	
Operating Temperature	-40°C to +70°C
Storage Temperature	-55°C to +85°C
Location	For Indoor use

Broadcast



Marine Oil & Gas



SNG & VSAT



Satellite Teleport

