



Model Number:
WGBCX-1880-A

RF Components

C-Band Waveguide E Plane Bend

3.95-5.85 GHz

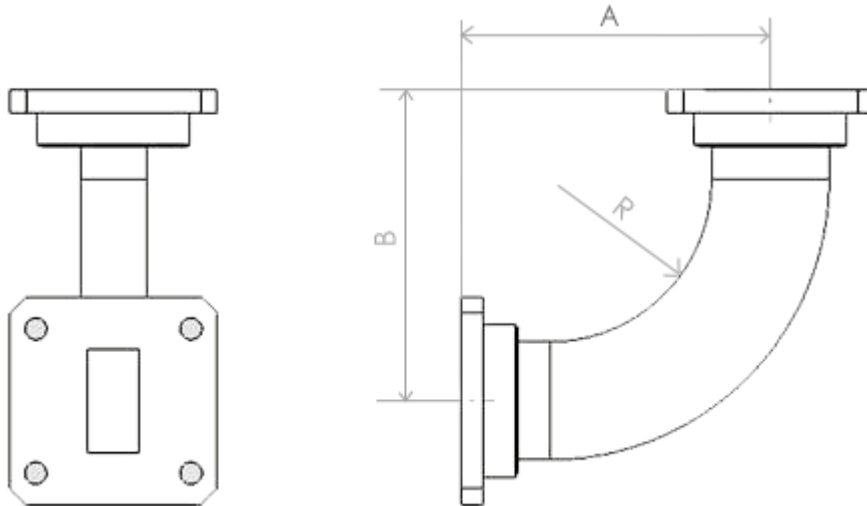

Specification		
WGBCX-1880-A	CGCG	UFUG
Waveguide Size	WG12/ WR187 / R48	
Flange 1	CPRG 48	UG407/U Circular Cover
Flange 2	CPRG 48	UG406B/U Circular Choke / Grooved
Flange Material/Finish	Aluminium Flanges Aluminium WG Black Finish	
Frequency Range	3.95-5.85 GHz	
VSWR / Return Loss	1.05 / 32.2 dB	1.1 / 26.4 dB
Power	1005 kW - Max	1.5 mW—Max
Dimension A	100 mm	
Dimension B	100 mm	
Bend Angle	90 degrees	
Radius	70 mm	

Broadcast



Marine Oil & Gas



SNG & VSAT



Satellite Teleport

