



RF Components

L-band Passive Equalisers

850 - 2150 MHz

Model Number:
EQU1P-4565

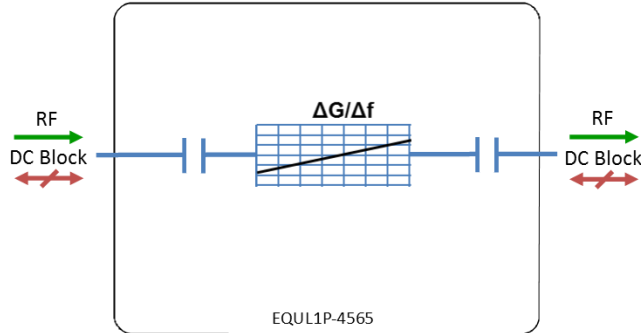

Description specific to each product

- Reciprocal device
- DC block between the 2 ports
- 13dB positive slope

Available with RF connector options:

- 50 Ω SMA
- 50 Ω N-type
- 50 Ω BNC



850-2150 MHz
Operating frequency
range. L-Band ready



Compact
Housed in
rugged compact
enclosure



**Flexible
Mounting**
Tapped screw &
through hole
mounting options

RF Parameters			
EQU1P-4565-xxxx	S5S5	N5N5	B5B5
Frequency Range	850 - 2150 MHz		
RF Connectors	50 Ω SMA	50 Ω N-Type	50 Ω BNC
Slope Positive (dB)	13 \pm 2.0	13 \pm 2.0	13 \pm 2.0
Input Return Loss (dB)	Typ.	15	15
	Min	12	12
Output Return Loss (dB)	Typ.	15	15
	Min	12	12

Broadcast



Marine Oil & Gas



SNG & VSAT



Satellite Teleport





RF Components

Model Number:

EQUL1P-4565

L-band Passive Equalisers

Technical specifications and operating parameters

Environmental		
Operating Temperature		0°C to +45°C
Storage Temperature		-20°C to +75°C
Location		Indoor use Only
Humidity	Max	85% non-condensing
Altitude	Max	10,000 feet

Max Operating Parameters	
Input RF Power	+16dBm
DC Voltage	35V on any RF port
DC Current	500mA
DC Consumption	100mA , 80mA(typ)

! Operation beyond these limits may cause instantaneous and permanent damage.

Physical Dimensions (mm)

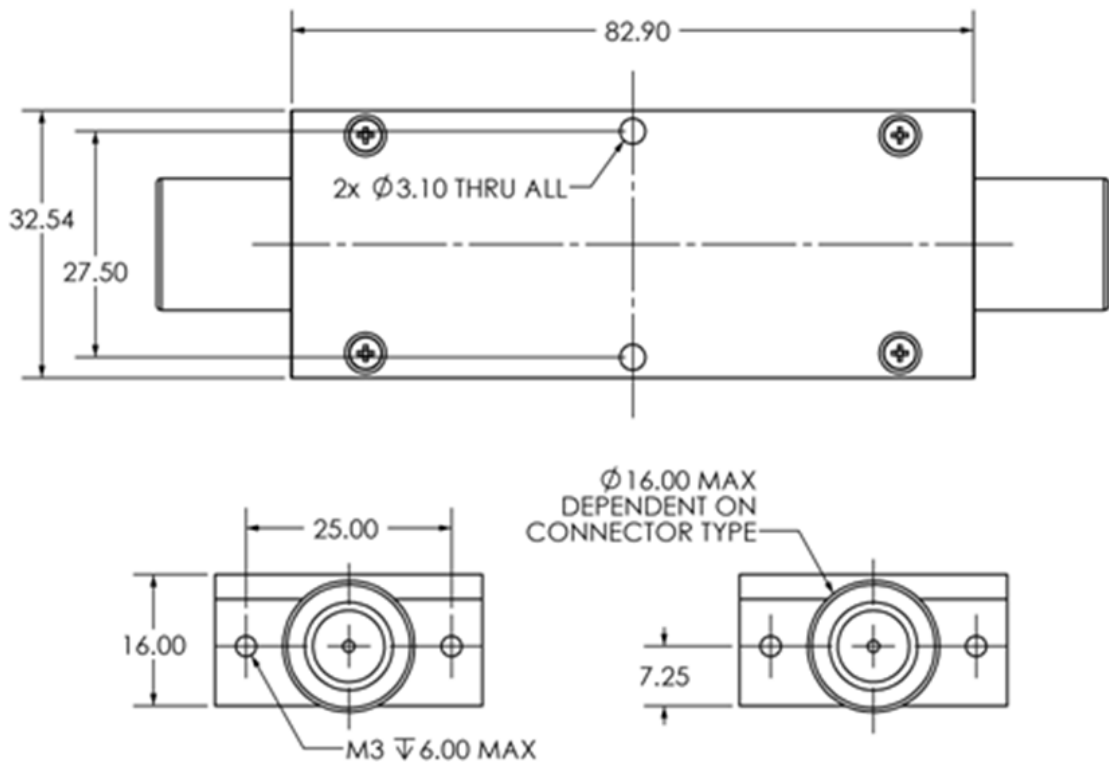

Note: The specification is subject to regular reviews and will be updated from time to time as part of our continuing product development and improved specification accuracy.

ETL SYSTEMS LIMITED
Coldwell Radio Station
Madley
Hereford
England HR2 9NE

TELEPHONE
+44 (0)1981 259020

EMAIL
info@etlsystems.com

FACSIMILE
+44 (0)1981 259021

WEB
www.etlsystems.com

