



RF Components

8-way L-Band Active Splitter

850-2150MHz

Model Number:
DIV08L1A-2443

- DC pass from Port 1 to the common port all other ports are DC blocked
- LNB inject line offering DC inject from external or inline power
- Requires 8-24V on port 1 or via LNB inject
- Unity gain

Available with RF connector options:

- 50 Ω SMA
- 50 Ω N-type
- 50 Ω BNC
- 75 Ω BNC
- 75 Ω F-type

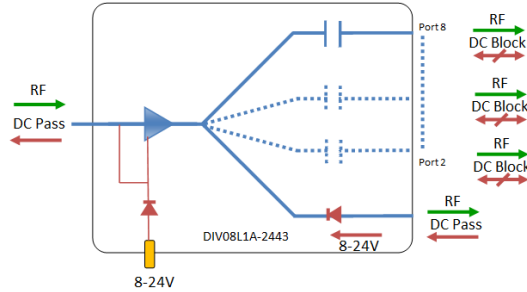

Flexible Mounting

Tapped screw & through hole mounting options

Compact

Housed in rugged compact enclosure

850-2150 MHz
Operating frequency range.

8-24V
External DC powering



RF Parameters

| DIV08L1A-2443 | | S5S5 | N5N5 | B5B5 | B7B7 | F7F7 |
|-------------------------|------|--------------|------------|---------|---------|------------|
| Frequency Range | | 850-2150 MHz | | | | |
| RF Connectors | | 50Ω SMA | 50Ω N-Type | 50Ω BNC | 75Ω BNC | 75Ω F-Type |
| Mean Gain (dB) | | 0 ±1.0 | 0 ±1.0 | 0 ±1.4 | 0 ±2.0 | 0 ±2.0 |
| Flatness ± (dB) | | 1.0 | 1.0 | 1.0 | 1.5 | 1.5 |
| Input Return Loss (dB) | Typ. | 18 | 18 | 16 | 14 | 14 |
| | Min | 12 | 12 | 12 | 8 | 8 |
| Output Return Loss (dB) | Typ. | 18 | 18 | 16 | 14 | 14 |
| | Min | 12 | 12 | 12 | 8 | 8 |
| Output P1dB GCP* (dBm) | Typ. | 0 | 0 | 0 | 0 | 0 |
| | Min | -2 | -2 | -2 | -2 | -2 |
| Isolation (dB) | Typ. | 25 | 25 | 25 | 25 | 25 |
| Output IP3 (dBm) | Typ. | 10 | 10 | 10 | 10 | 10 |
| Noise Figure (dB) | Typ. | 6 | 6 | 6 | 6 | 6 |

*GCP (Gain Compression Point)

Broadcast



Marine Oil & Gas



SNG & VSAT



Satellite Teleport



Technical specifications and operating parameters

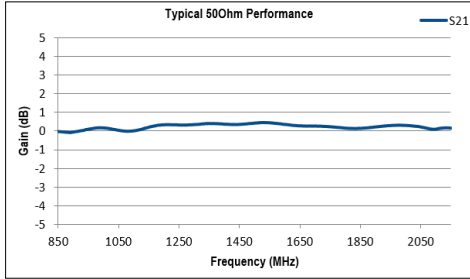

Gain (dB)

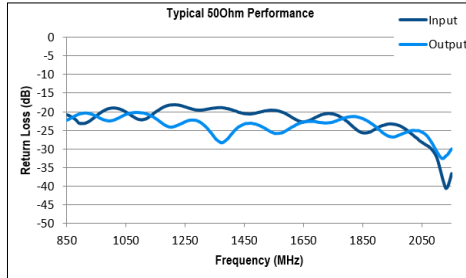

Return Loss (dB)

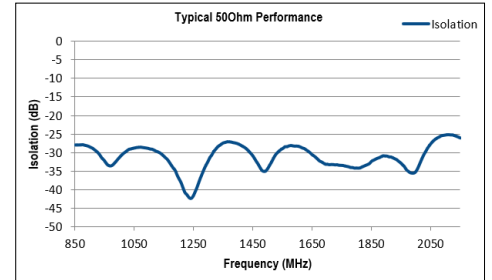

Isolation (dB)

| Environmental | | |
|-----------------------|-----|--------------------|
| Operating Temperature | | 0°C to +45°C |
| Storage Temperature | | -20°C to +75°C |
| Location | | Indoor use Only |
| Humidity | Max | 85% non-condensing |
| Altitude | Max | 10,000 feet |

| Max Operating Parameters | | |
|--------------------------|-----|-------------------------|
| Input RF Power | | +16 dBm (40mW) |
| DC Voltage | | 35V on any RF port |
| DC Current | Max | 1A |
| DC Consumption | | 100mA Max, 80mA typical |

! Operation beyond these limits may cause instantaneous and permanent damage.

Physical Dimensions (mm)

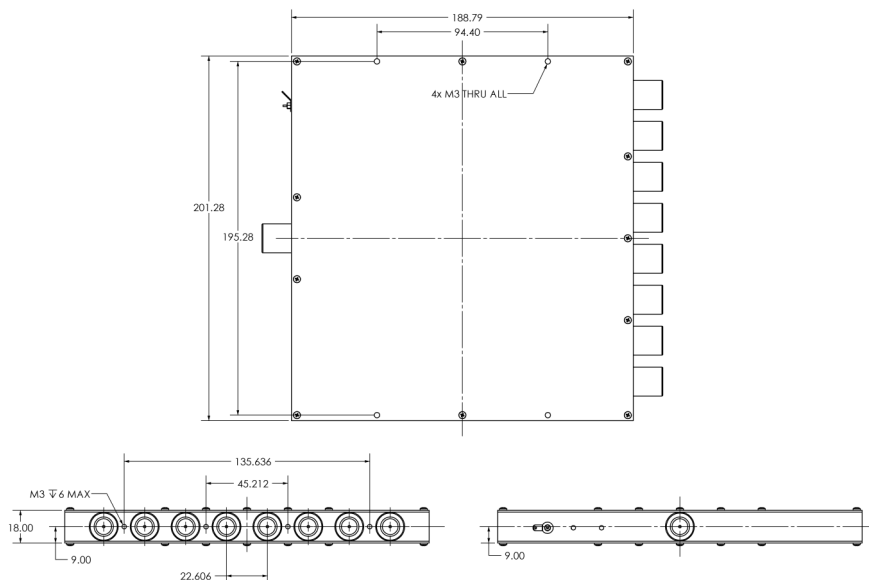

Note: The specification is subject to regular reviews and will be updated from time to time as part of our continuing product development and improved specification accuracy.