



Model Number:  
**COM02CXP-2787**

RF Components

# IP67 2-Way Wideband Passive Splitter/Combiner

2-6 GHz

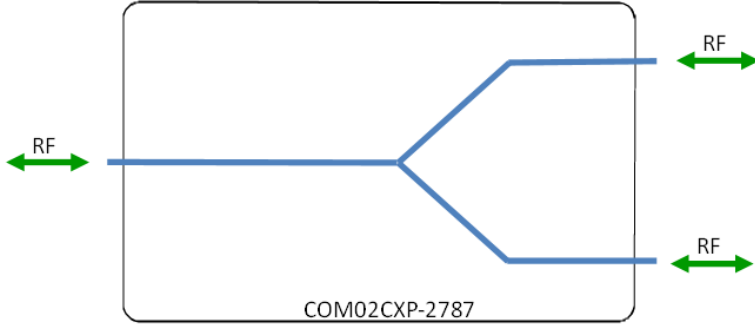

Available with RF connector options:  
• 50 Ω N-Type



# Passive

RF Parameters		
COM02CXP-2787-XXXX		N5N5
Frequency Range		2 - 6 GHz
RF Connectors		50Ω N-Type
Insertion Loss (dB)		3.2
Input Return Loss (dB)	Typ.	22
	Min	20
Output Return Loss (dB)	Typ.	22
	Min	20
Isolation (dB)	Typ.	8
	Min	6
Amplitude Balance (dB)		≤ ± 0.2
The given Insertion Loss specified is the loss above the theoretical limit for a lossless divider		

### Broadcast



### Marine Oil & Gas



### SNG & VSAT



### Satellite Teleport





RF Components

Model Number:  
**COM02CXP-2787**

*IP67 2-Way Wideband Passive Splitter/Combiner*

### Technical specifications and operating parameters

Environmental		
Operating Temperature		-45°C to +90°C
Storage Temperature		-40°C to +85°C
Location		Indoor / Outdoor IP67* rated
Humidity	Max	85% non-condensing
Altitude	Max	10,000 feet

Max Operating Parameters	
Input RF Power	300W as splitter
DC Voltage	N/A
DC Current	N/A

\*IP67 integrity is maintained by populating all ports with sufficiently rated connectors and that unused ports have IP67 terminators or dust caps when awaiting connection. Dust caps are not sold with this product.

**!** Operation beyond these limits may cause instantaneous and permanent damage.

### Physical Dimensions (±0.3mm)

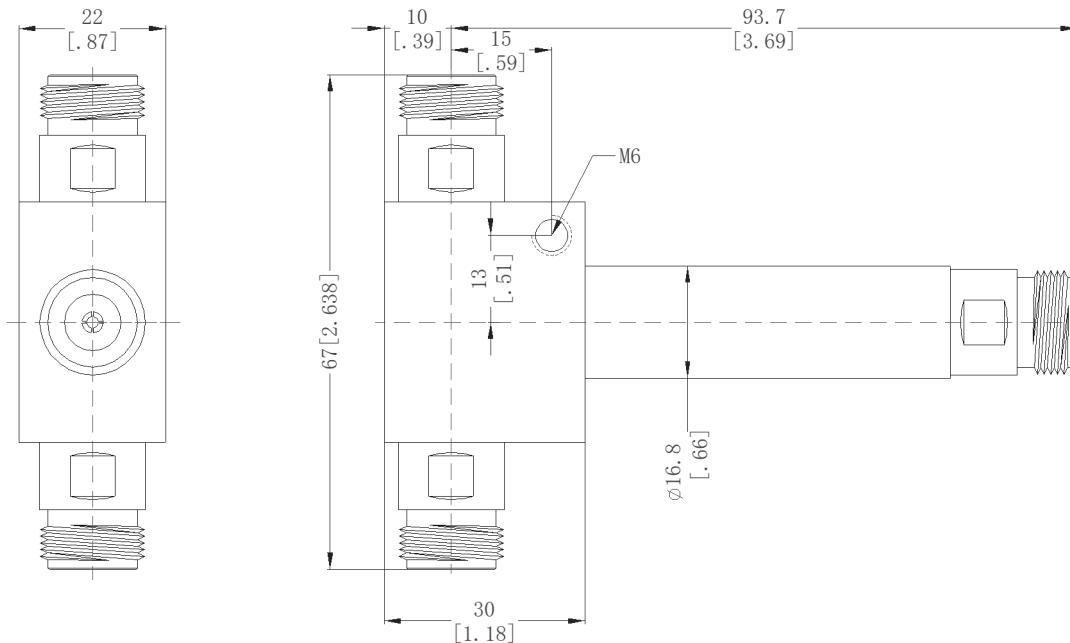

Note: The specification is subject to regular reviews and will be updated from time to time as part of our continuing product development and improved specification accuracy.

ETL SYSTEMS LIMITED  
Coldwell Radio Station  
Madley  
Hereford  
England HR2 9NE

TELEPHONE  
+44 (0)1981 259020  
  
EMAIL  
info@etlsystems.com

FACSIMILE  
+44 (0)1981 259021  
  
WEB  
www.etlsystems.com