



18x1 SHF Switch

with indicator contacts, GUI aliases and local control and monitoring via ethernet & serial ports

Typical applications:

- Signal carrier monitoring of satellite feeds
- Redundancy switching for main applications.
- Remote controlled unmanned satcom sites
- Routing signal to multiple IRDs



Resilience from dual redundant and alarmed power supplies



DC - 40 GHz operating frequency range



Local control & monitoring via front panel push buttons & display



Compact housed in a 2U high chassis

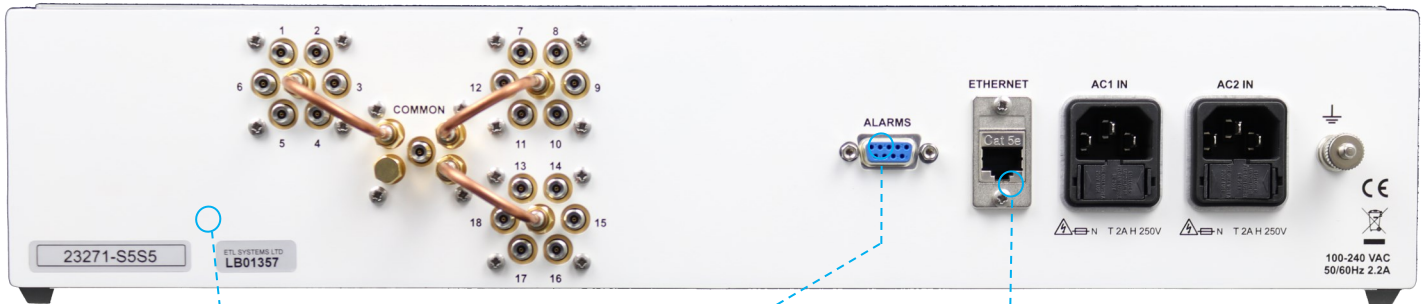
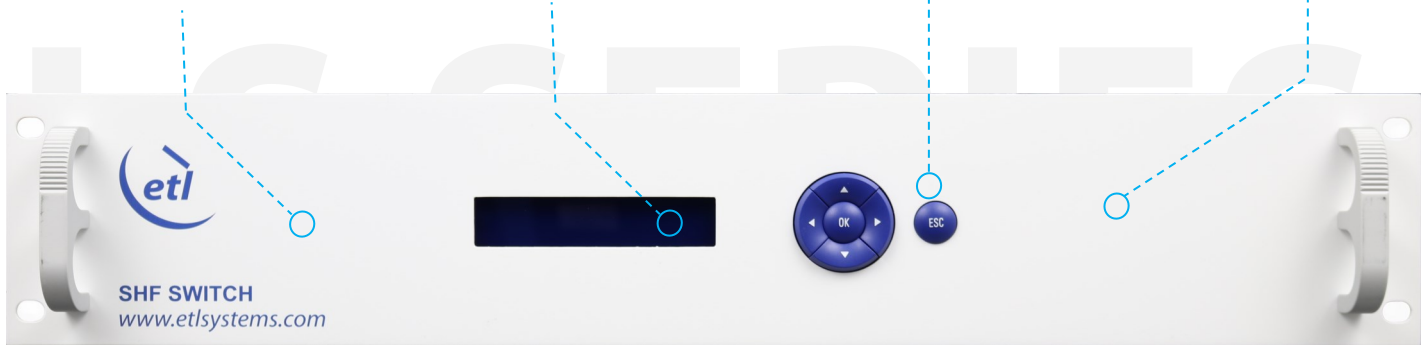

Improved Performance with faster switching time, improved return loss & isolation



Dry contact alarm port & serial communications for amplifier & power supply status



Remote control & monitoring via RJ45 Ethernet port with SNMP & web browser interface





Technical specifications and operating parameters

| RF Parameters | | | | | | | |
|-----------------------------|----------------------------------|------|--------|---------|---------|---------|---|
| Capacity | 18-way Switch | | | | | | |
| Frequency Range | DC-40 GHz (Super High Frequency) | | | | | | |
| RF Connectors | 50Ω 2.92mm (K) | | | | | | |
| Frequency bands (GHz) | 0-3 | 3-8 | 8-12.4 | 12.4-18 | 18-26.5 | 26.5-40 | |
| Insertion Loss (dB) | 0.8 | 1.0 | 1.2 | 1.5 | 2.0 | 3.5 | |
| Flatness (dB) | ±0.5 | ±0.5 | ±0.5 | ±0.5 | ±0.75 | ±1.5 | |
| Return Loss (Any port) (dB) | Typ | 22 | 18 | 18 | 16 | 16 | 8 |
| | Min | 18 | 14 | 14 | 12 | 10 | 6 |
| Isolation (dB) | 68 | 80 | 80 | 80 | 70 | 65 | |
| Input RF Power (dBm) | 16 | 16 | 16 | 16 | 16 | 16 | |

| Power | | |
|----------------|--------------------------|----------------------------------|
| PSU Power | 85-264Vac 50-60Hz | Fused 2A |
| PSU Redundancy | Dual redundant & alarmed | Diode OR. |
| AC Consumption | 30W | Max. consumption at steady state |

| Environmental | | |
|-----------------------|--------------------------|----------------------|
| Operating temperature | 0 to 45°C | |
| Location | Indoor use only | |
| Storage temperature | -20°C to +75°C | |
| Humidity | 20 to 90% non-condensing | Relative Humidity |
| Altitude | 10,000 feet AMSL | Above mean sea level |

| System Control | | |
|-----------------------------|--|--|
| Local Control | Via front panel LCD & push buttons | |
| Remote Control & Monitoring | Ethernet (RJ45) with SNMP & web browser interface | Enables control and monitoring and alarms status |
| Alarms | Dry contact (D-type) & Ethernet (RJ45) PSU & summary alarms (D-type) ETL protocol / Web GUI / SNMP (RJ45) | |
| Switch Life | 2,000,000 cycles per position | |

| Physical | |
|------------|---------------------------------|
| Dimensions | 2U high x 500mm deep x 19" wide |
| Weight | 6 kg |
| Colour | White 00-E-55 semi-gloss |

Note 1: The specification is subject to regular reviews and will be updated from time to time as part of our continuing product development and improved spec accuracy.

Note 2: Operation beyond the quoted limits stated above may cause instantaneous and permanent damage.

