

## 2-way Passive C-band Splitter/Combiner



COM02C1P-2547 is a 2-way passive C-band (3.5 to 4.2 GHz) splitter/combiner.

This component is available with the following RF connector options: 50  $\Omega$  SMA & 50  $\Omega$  N-type.

Summary table for RF performance over C-band operation, 4.2 GHz to 6.5 GHz

Model Numbers	Conn.	Insertion Loss* (dB)		Isolation Typical (dB)	Return Loss (dB)		Phase & Amplitude Misalignment	
		Typ.	Max		Typ.	Min	$\Phi$	Amp(dB)
COM02C1P-2547-S5S5	50 $\Omega$ SMA	0.5	0.8	20	18	12	0.15	0.15
COM02C1P-2547-N5N5	50 $\Omega$ N-type	0.6	1.0	20	15	10	0.20	0.15

\*The quoted insertion loss is loss above theoretical due to power split. For 2-way splitters theoretical value is 3dB. Typical values may vary between different production batches.

Maximum acceptable operating parameters for reliable and safe operation

Parameter	Value	Comment
Input RF power	+37 dBm (5W)	Max total RF power
DC Voltage	50V	Any RF port
Operating temperature	0 to 45 C	Indoor use only
Storage Temperature	-20 C to +75 C	
Humidity	85%	Non-condensing

**!** Operation beyond these limits may cause instantaneous and permanent damage.



### Vector diagram & physical dimensions

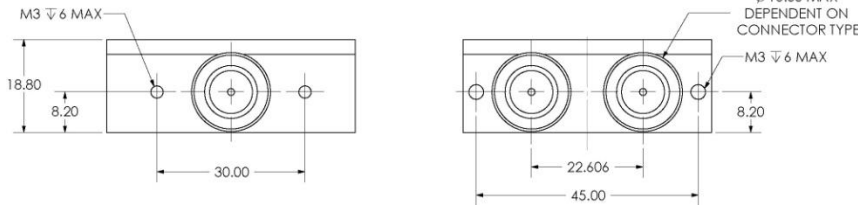
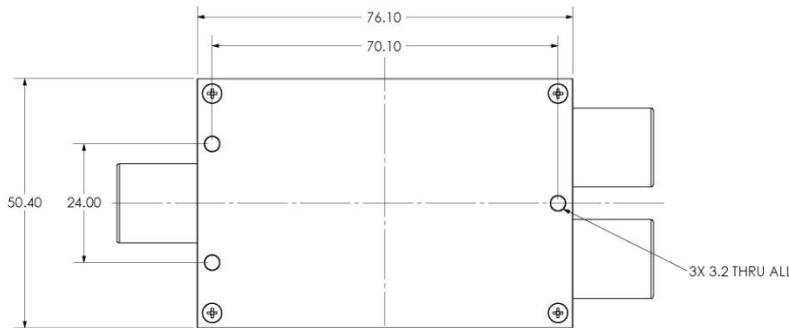

**N.B: The housing and fixing holes may vary from time to time. This would be to expedite delivery by using an alternative suitable, similar housing. If this is a concern please advise with your order.**

Alternative 2-way Passive C-band splitters/combiners (figures may vary based on connector types)

Model Number	Frequency	Insertion Loss Typical (dB)	Isolation Loss Typical (dB)	Return Loss Typical (dB)
COM02C2P-2548	5.8-6.5 GHz	0.5	20	18
COM02C3P-2549	3.5-6.5 GHz	0.6	20	15